

ASSEMBLY INSTRUCTION

PLEASE READ BEFORE ASSEMBLING!

Tip #1: Make sure you've taken all the pieces and hardware out of its packaging before discarding the box. Assembly on top of flattened box/blanket is recommended.

Tip #2: Using page 2 and/or page 3 of instruction manual make sure all pieces and hardware are accounted for.

Tip #3: Note position of all holes on each panel during assembly.

ITEM#: 8066-3

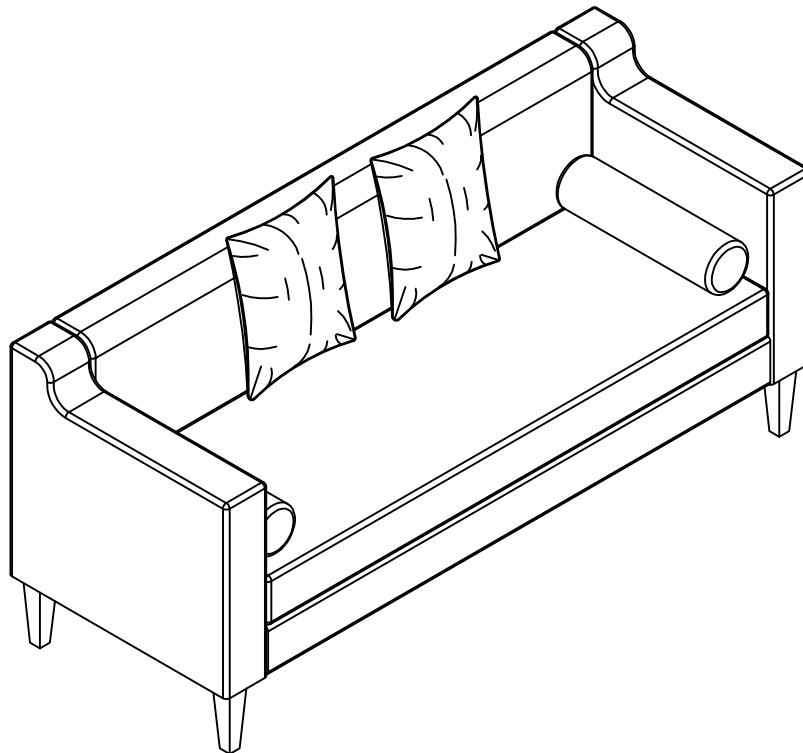

PARTS IDENTIFICATION

ITEM#: 8066-3

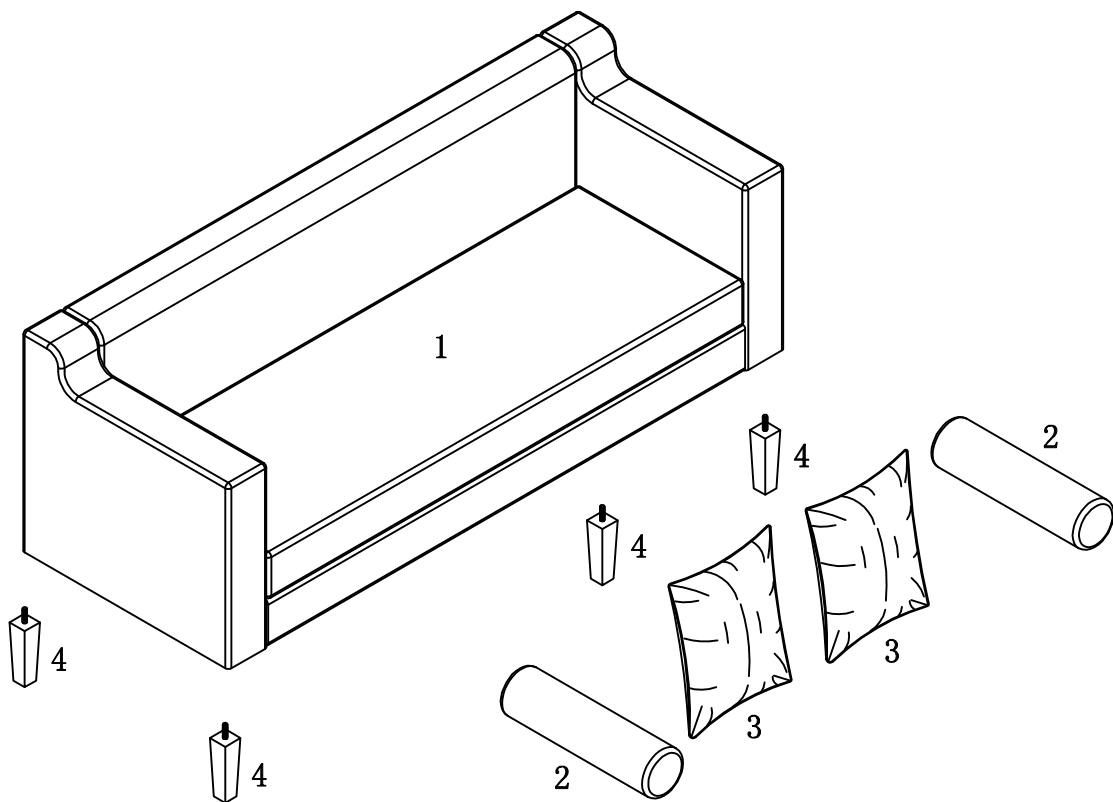

- | | |
|-----|------|
| (1) | 1pc |
| (2) | 2pcs |
| (3) | 2pcs |
| (4) | 4pcs |

ASSEMBLY INSTRUCTION

ITEM#: 8066-3

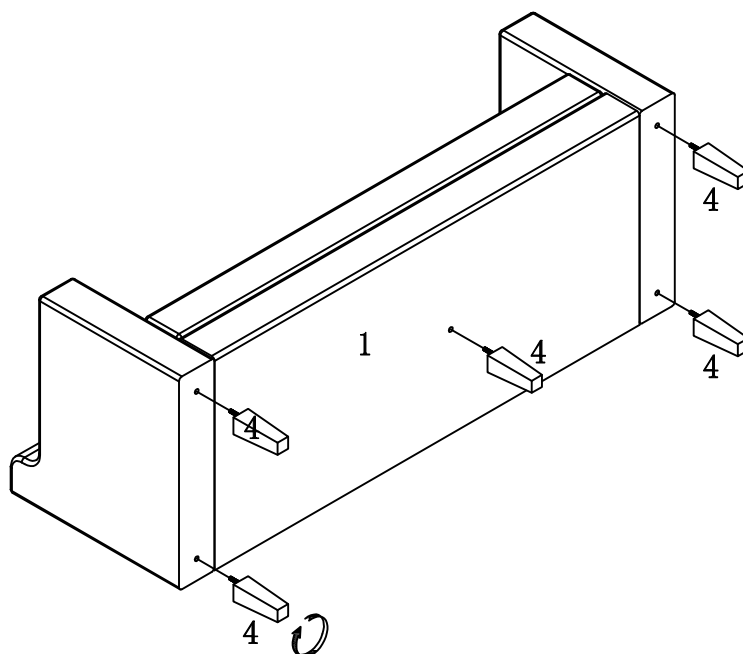

STEP1

STEP2

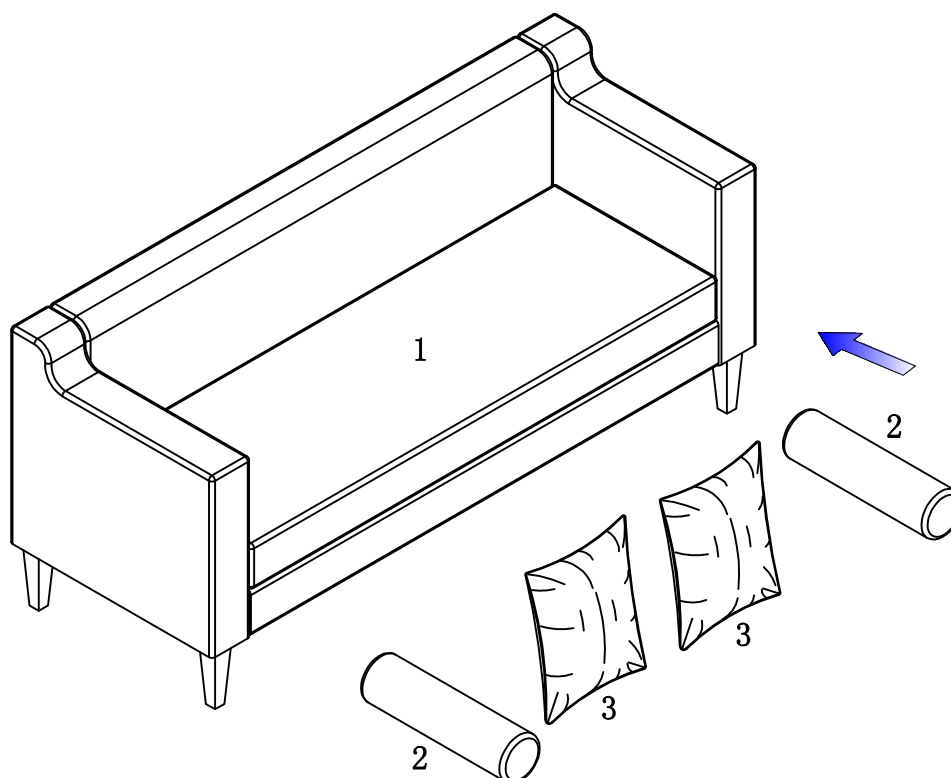

PAGE 3 OF 4

ASSEMBLY INSTRUCTION

ITEM#: 8066-3

STEP3

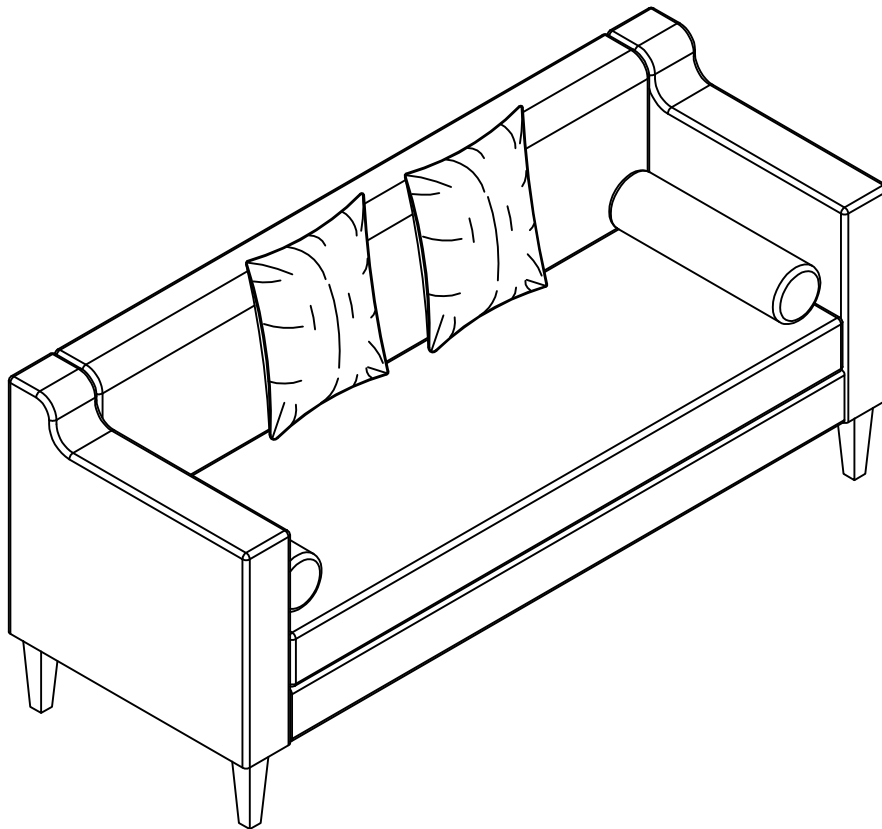

Assembly is complete.

Treat surfaces with care. wipe clean with a dry or damp soft cloth. Do not use abrasive cleaners.

PAGE 4 OF 4